

NORTHROP & JOHNSON



Triumphant Lady

47.24m (154'11"ft) | Sterling Yachts | 1985

Triumphant Lady is a magnificent All Oceans Yacht which was recently upgraded for circumnavigation. An extensive refit and hull extension ensued and now this 1985 luxury motor yacht boasts the ability to sail anywhere at anytime. Luxurious and reliable, with state of the art equipment and a top speed of 14.5 knots, Triumphant Lady is for all intents and purposes a 2009 vessel. She offers accommodation for up to 10 guests.

Price

\$8,900,000

Details correct as of 29 Mar, 2015

FOR SALE

Cabins:	5
Guests:	14
Crew:	9
Beam:	8.10m (26'6"ft)
Draft:	2.29m (7'6"ft)
Speed:	13.00 kts
Built/Refit:	1985 / 2009

View online at

<http://www.superyachts.com/luxury-yacht-for-sale/triumphant-lady-682/>

TRIUMPHANT LADY

47.24m (154'11"ft) | 1985

COMMUNICATION

VSAT Satellite Communication System (52 inch dome)

Voice, Data, Internet, Thrane & Thrane FB500 Fleet Broadband SATCOM

Voice, Data, Internet, Iridium Beam RST100A

Voice, data, Internet Panasonic Telephone switchboard System with 18 internal extensions Ericsson W25 Quad band GSM Cellular Phone.

Wireless Internet throughout the vessel with 19" LCD TV for ELBEX CCTV and Email Server ICOM M604 VHF/Hailer, ICOM FM-8500 VHF

STS 1000 Wi-Fi Bridge Adapter with 24-port 10/100/1000 Gigabyte switch 5 WAP's strategically placed through out vessel 7 Hard wired

LAN locations situated throughout vessel.

Email Server and Router Computer

Vei Marci Pro Pentium – 1 Gig RAM

80 Gig DH with MDEAMON software

AUDIO & VISUAL EQUIPMENT

2 x Aqua Air Handlers with controllers

2 x Battery banks and chargers

4 x Samsung LCD TV

Direct TV Receiver

Denon AVR 1909 Dolby Pro 11X surround receiver

Surround speaker system with Velodome 10" subwoofer and 9 x Speakercraft speakers

iPod docking stations x 2

Speakercraft hand held RF keypads x 2

Audio Technics wireless microphones x 2

JVC Karaoke/Video Player XL-SV22

Denon DVD 758 Region Free DVD Player

Niles S1-1230 12 channel power AMP

TENDER & TOYS

Scuba Diving gear and water sports equipment

Featuring a Clark Compressor and Kaeser Nitrox (40%) compressor recently overhauled and meticulously maintained

The Cramm hydraulic Aft passarelle with double S/S hand rails is housed outboard

Marine Air Handler

AMENITIES

Gym

Jacuzzi

TRIUMPHANT LADY

47.24m (154'11"ft) | 1985

YACHT LAYOUT

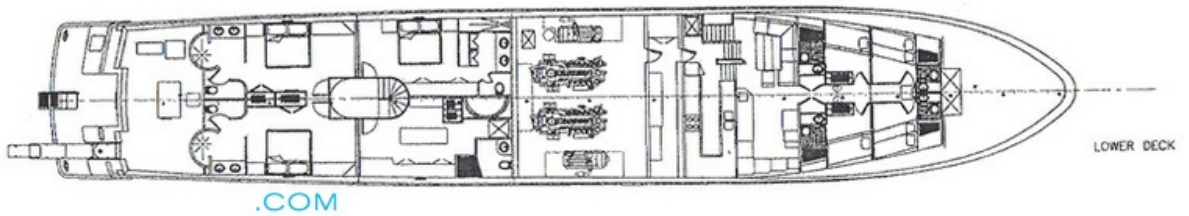
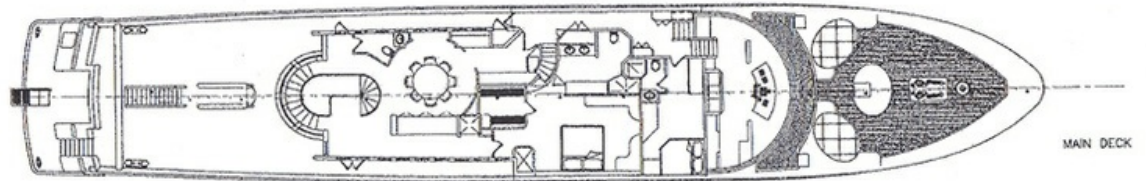
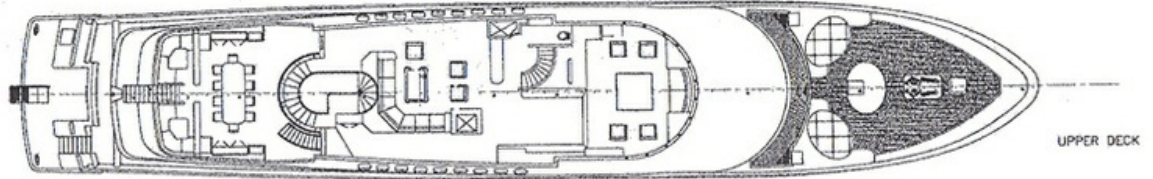
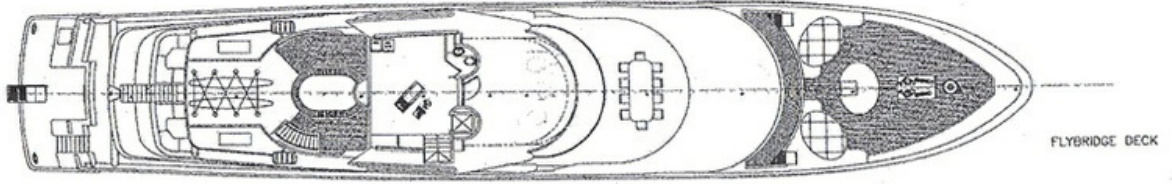

TRIUMPHANT LADY

47.24m (154'11"ft) | 1985



TRIUMPHANT LADY

47.24m (154'11"ft) | 1985



TRIUMPHANT LADY

47.24m (154'11"ft) | 1985

SPECIFICATIONS

Overview

Name:	Triumphant Lady
Type:	Motor Yacht
Model:	Custom
Sub Type:	
Builder:	Sterling Yachts
Naval Architect:	
Exterior Designers:	Jon Bannenberg
Interior Designer:	
Year:	1985
Flag:	Marshall Islands
MCA:	
Class:	ABS
Hull NB:	-
Hull Colour:	White

Dimensions

Length Overall:	47.24m (154'11"ft)
Length at Waterline:	-
Beam:	8.10m (26'6"ft)
Draft (min):	-
Draft (max):	2.29m (7'6"ft)
Gross Tonnage:	-

Accommodations

Guests:	14
Cabins Total:	5
Cabins:	-
Crew:	9

Construction

Hull Configuration:	-
Hull Material:	GRP
Superstructure:	Aluminium
Deck Material:	Teak
Decks NB:	-

Engine(s)

Quantity:	2
Fuel Type:	Diesel
Manufacturer:	Caterpillar
Model:	3512 TA
Power:	- / -
Total Power:	- / -
Propulsion:	-

Performance & Capabilities

Max Speed:	15.00 kts
Cruising Speed:	13.00 kts
Range:	-
Fuel Capacity:	62,281.43 L / 13,700.00 USG
Water Capacity:	-

Equipment

Generator:	2 x Northern Lights 130 kW
Stabilizers:	Quantum Zero Speed
Thrusters:	-
Amenities:	-